

ETHERNET

OPTION



**INSTALLATION & OPERATION
GUIDE**



INDEX

Description	5
Box contents	6
Previous requirements	7
Option card	8
Option installation	10
Verifying Option installation on Plotter	11
Verifying Option installation on Software	12
Assembly and Setup	13
Technical Service	16
Notes	17



DESCRIPTION

Ethernet option allows the plotter to communicate with the software using a lan TCP/IP connection.

It has some benefits due to physical flexibility in the installation. USB cable has a maximum length of 5m from the computer to the plotter. On the other hand, ethernet allows to work far away from the server computer.

The plotter has also implemented some other lan protocols as:

- PING for device setup.
- DHCP for automatic IP address asignment in an easy configuration.

BOX CONTENT

Check the boxes to verify that all parts are present.

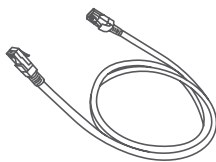

x1
Ethernet cable

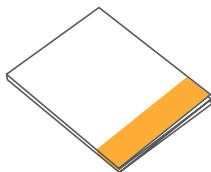

x1 - Installation & Operation guide



x1 - Activation
card



PREVIOUS REQUIREMENTS

- User must guarantee a confident lan (the less overloaded the better), with free IP address that can be assigned to the plotter.
- Check that the lan port is operative before plug-in the plotter.
- The Server Manager and the plotter must be working in the same lan.
- Verify that the plotter firmware version is higher than 6.0.0.0.

To find out your plotter's firmware version, go to:

Menu > Options > Info> Firmware versions

OPTION CARD



TDOT

POWERFULLY REIMAGINED



OPTION INSTALLATION

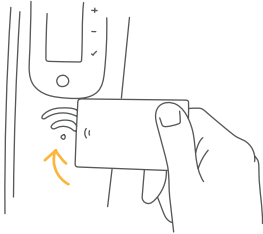

01. Get the option card and pass it through the RFID zone (on the right side panel) for at least 2 seconds, until you hear the acoustic signal.

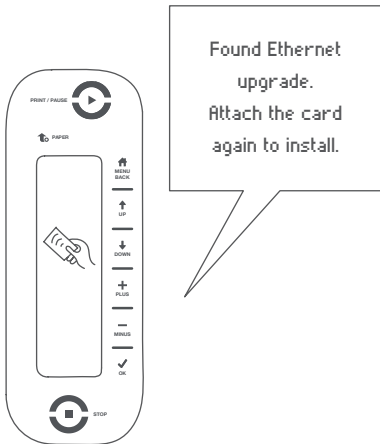

02. Check the verification message installation in the display.

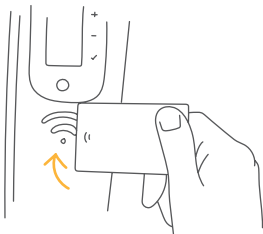

03. Pass again the card to validate the installation, until you hear the acoustic signal.

VERIFYING OPTION INSTALLATION ON PLOTTER

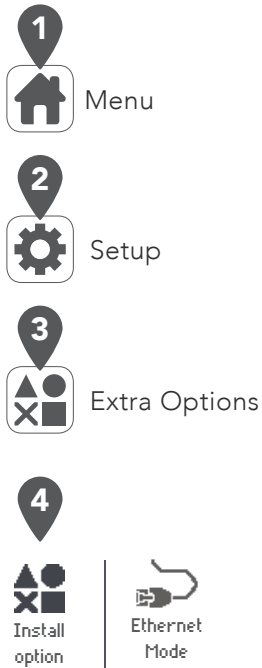

On the operator panel keyboard press the Menu button. (1)

Select the Setup menu (2) and press Ok.

Select the Extra Options menu (3) and press Ok.

Check the installation of the **Ethernet** option. (4)

Press the Menu button to get back.

VERIFYING OPTION INSTALLATION ON SOFTWARE

In the main User Manager screen select the “Customer Programs” (1) and select “Plug-ins and Options” (2). Check that the **Ethernet** option is correctly installed (3). Press Accept to exit.

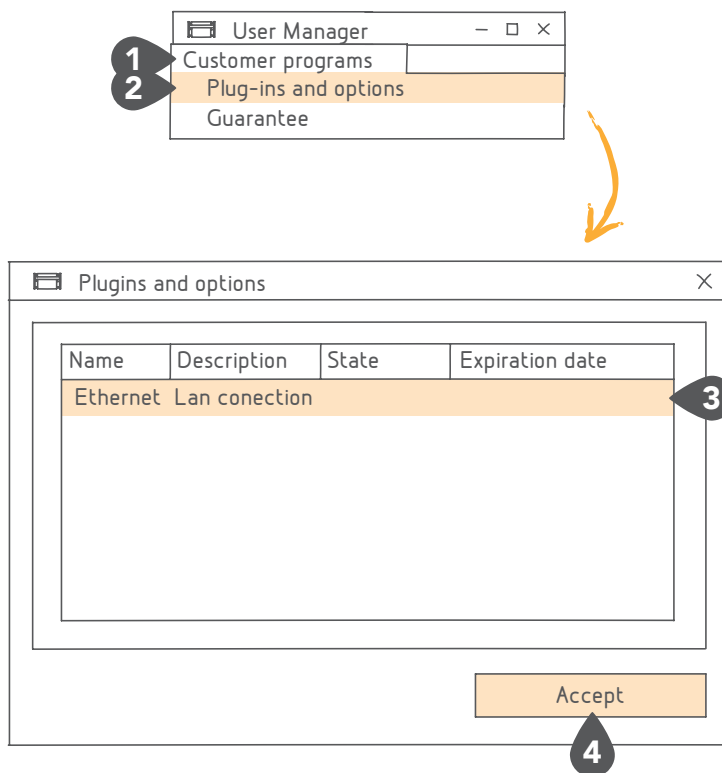

- * To verify the installation using the lan connection the server must be configured previously.

ASSEMBLY AND SETUP

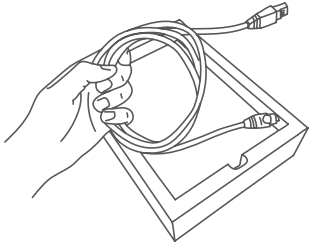

- 01.** Take out from the box the ethernet cable.

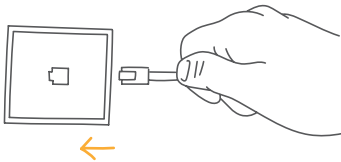

- 02.** Connect one side of the cable to the lan plug.

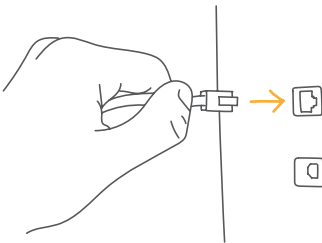

- 03.** Connect the other side to the plug in the back of the plotter.

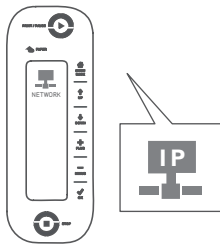

- 04.** Check and/or select IP address.

ASSEMBLY AND SETUP

4 A. Automatic IP selection.

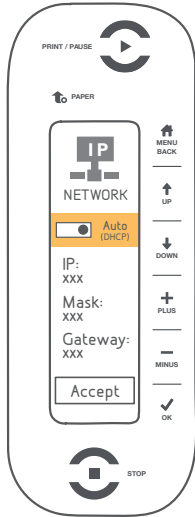

Check IP (on the DHCP mode enabled). Go to:
Menu>Setup>Network
Enable DHCP mode with "+" and "-" keys.
>Accept

4 B. Manual IP selection.

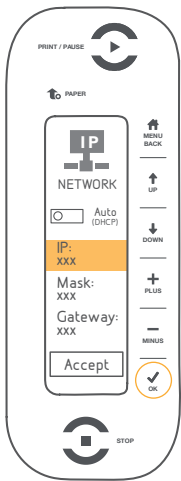

Disable DHCP mode with "+" and "-" keys.
Select the IP field using the arrow key and press OK to go in.
Repeat for "Mask" and "Gateway".

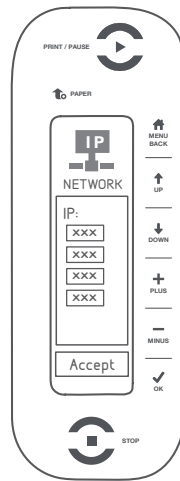

Change the values with "+" and "-" keys.
Move between digits with the arrow key.
Accept to validate.

- 05.** In the Server Manager. (1) select the Plotter, (2) stop it and (3) press the configuration button. In the configuration form (4) select the Ethernet connection in the combo box and (5) set the plotter IP address obtained from the display. (6) Press Accept to save the changes.

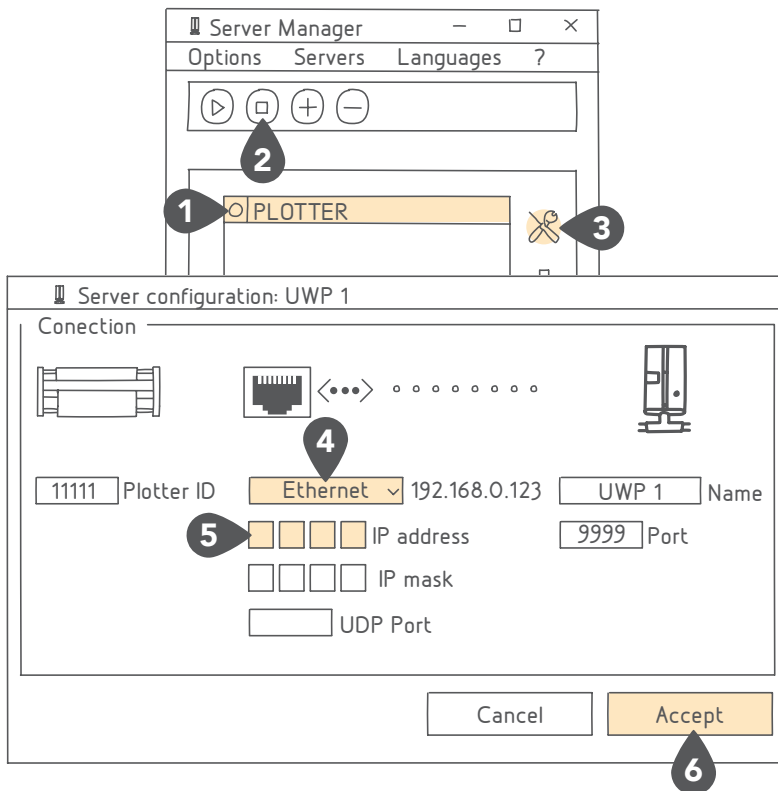

TECHNICAL SERVICE

Please contact your dealer for technical support in case of any issue.

NOTES

204445_190701